

KM-2560/KM-3060

▶ print ▶ copy ▶ scan ▶ fax

A3 MULTIFUNCTIONALS

TREATS EVERY PROJECT
AS A PRIORITY.



 KYOCERA

NO NEED TO WAIT YOUR TURN.

PREDICTABLY RELIABLE WORKFLOW

It's easy to get used to not having to wait. With new Kyocera technology that processes multiple jobs simultaneously, you can safely predict that no one in the office will be on standby. While one person is printing from one corner of the office, another can be scanning. Meanwhile, if someone in another area of the office decides to print, their job is ready to go the moment the first print job is finished.

With Kyocera, reliability is as important as productivity. Long-life components and exceptionally hard-wearing Kyocera drums make it easy to predict that these multifunction devices will work hard to maximise working hours (theirs, not yours). Less downtime is something everyone in the entire workgroup can get used to. At least, until it's time to go home.

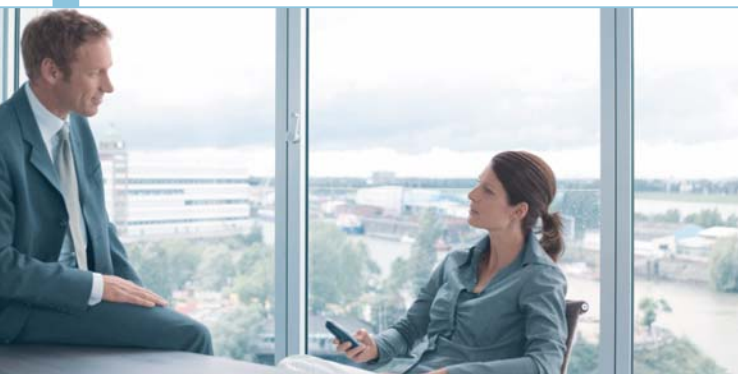

Ask anyone in the office “Whose project is the most important?” and they will all say “Mine!”. Luckily there are Kyocera multifunctional devices that can handle all the demands of a networked workgroup. The new KM-2560 and KM-3060 make use of new dataprocessing technology to allow simultaneous processing of multiple jobs. Now everyone can have their turn at the same time.

Duplex colour scanning

Scan both sides of your documents in full colour.

Colour touch panel with thumbnail previews

Intuitive menus with easy-to-view colour thumbnails.

Extra security enhancements

Accommodates extra security requirements for networked environments.

Optional internet fax

Conveniently fax over the internet, directly to a PC.

80 GB document box as standard

A large hard disk lets you save, retrieve and output documents directly from the device.

Long-life components

Durable components increase longevity and reduce downtime.



MULTI-TASK AND MULTI-SEND ACROSS THE NETWORK

Not only do these multifunction devices allow multi-tasking, they also allow multiple people to multi-task. As if that weren't enough work for one day, they also allow multi-sending. Multi-sending means scans can be sent to different places at the same time. With an integrated address book that holds up to 2,000 destinations, a long list of people can receive the information they require, at precisely the time they need it.

COLOUR TOUCH PANEL WITH THUMBNAIL PREVIEW

With the potential to do so much at once, you might think it's easy to lose track of what you're doing. That's unlikely with a colour touch panel this large. To increase usability, the buttons and icons that people use most often are given priority. Related menu options are intuitively shown on the same screen. And it's easy to retrieve files stored in the 80 GB document box, by simply viewing colour thumbnails and previews.



8.5 inch colour touch panel with on-screen guidance.



Find the perfect viewing angle with the adjustable control panel.

DUPLEX COLOUR SCANNING OF MIXED-SIZE ORIGINALS



Just because you don't usually print in colour doesn't mean it wouldn't be nice to save documents in colour. The addition of the optional document processor not only enables colour scanning, it provides duplex colour scanning. Even if the original documents are different sizes, simply place them on the tray in one stack and the automatic document processor automatically scans them to size in one go, so you don't have to sort through them in advance.



ACCESSIBLE BY EVERYONE

A lot of thinking has gone into the inside of Kyocera multifunction devices, but what about the outside? On the KM-2560 and KM-3060 there's been equal attention paid to the interface between user and machine as there has been to the technology inside. These design features give everyone in the workgroup equal access, regardless of their strength or physical ability, and all contribute to better workflow in small but significant ways.



Easy scan access
Makes everyday scanning quick and easy.

Portable paper clip and staple case
Conveniently collect paper clips, or staples for the bin.

Cleaning cloth
At hand to keep the glass surface clean.

Adjustable opening angle
Keeps the automatic document processor within easy reach.

Adjustable control panel
Readable in all light conditions, including direct sunlight.

Internal multi-purpose tray
Space-saving cassette for a variety of print jobs.

Job status LED
Indicates job processing status, paper output and errors.

Easy-to-find output
Dark output trays provide a contrasting background for paper.

Easy to open paper cassettes
Ergonomic cassette handles can be pulled from top or bottom and allow a more natural grip.



PDF DIRECT PRINTING FROM USB

In addition to simultaneously processing jobs over the network, there is occasionally the need for non-network printing, perhaps to meet the requirements of guests in the office who aren't on the network. Equipped with two USB ports, the KM-2560 and KM-3060 offer PDF direct printing from USB memory sticks with no need for a PC. It's often the case that direct printing is simply more convenient, especially for spontaneous print jobs. Just walk up and print.

EXTRA SECURITY ENHANCEMENTS

The KM-2560 and KM-3060 are security-enabled multifunction devices designed for networked environments or for use in isolation within departments that frequently deal with confidential information. They offer IP filtering and security watermarks as standard, as well as optional features that are easy to add for extra security.

Security watermarks are particularly useful for preventing unauthorised copying of confidential documents. When printing, you can choose to automatically embed a faint pattern in documents that becomes more visible when copied. This watermark discourages unauthorised copying and makes it easy to identify whether a document is an original.

With the optional Data Security Kit, information stored on the hard disk (such as previous print jobs or details from the address book) can be encrypted and then completely over-written to safeguard data. Individuals can also be given the option to password-protect scanned documents by using the PDF expansion kit. If security was a concern, it needn't be any longer.

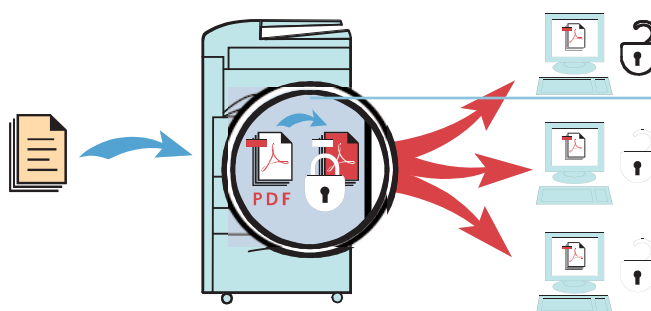

1. Set password when scanning.
2. Key in password to open PDF.

Security-enabled multifunction

The PDF expansion kit can be used within departments that deal with confidential information

SMALL FOOTPRINT WITH ROOM TO EXPAND

These compact multifunction devices incorporate a large built-in by-pass tray that holds 200 sheets of A4 paper, even when closed. Effectively this means the by-pass functions as a third cassette, which completely closes to suit confined spaces, such as near a shelf, filing cabinet or wall. In addition to smart features like this, the modular design means you can add paper handling and finishing functionality as needed.

Basic paper handling

Two 500-sheet paper cassettes and a 200-sheet multi-purpose tray provide a generous paper reserve.

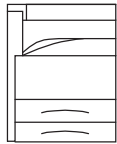

Standard configuration

Optional cabinet

An additional paper cabinet with rollers allows convenient paper storage.

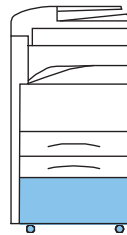

CB-670

Flexibility

Two additional 500-sheet paper cassettes offer fast, convenient access to multiple paper types.

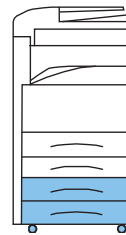

PF-670

Automatic document processor

A 75-sheet document processor can scan large stacks of double-sided colour originals.

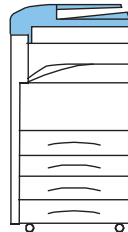

DP-670

Basic finishing

When a finisher is required, but you're short of space, you can add a 500-sheet internal finisher.

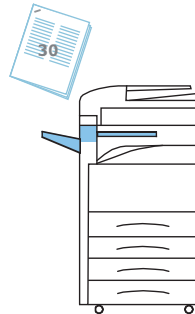

DF-670

More advanced finishing

An additional 1,000-sheet finisher staples large stacks of paper quickly and effortlessly.

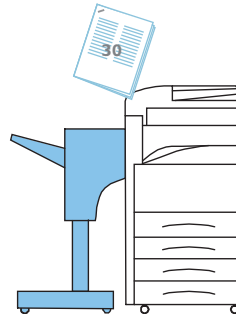

DF-730

WHEN EFFICIENT ADMINISTRATION IS A PRIORITY

One single tool is all it takes. Fast and highly efficient, KMnet Admin is a comprehensive, web-based application for device administration. The system supports most network printers, making it ideal for mixed environments. And because it is web-based, administrators can take care of print job management, accounting or even troubleshooting, no matter where they are. Best of all, this highly efficient tool is free of charge for Kyocera customers.

KM-2560/KM-3060

A3 MULTIFUNCTIONALS

The KM-2560 and KM-3060 incorporate extremely durable components that guarantee efficient and reliable operation to meet the demanding requirements of busy office environments. The KM-2560 and KM-3060 provide effective productivity and maximise uptime whilst ensuring a minimal impact on the environment.

GENERAL

Technology: Kyocera Laser, Mono component
Engine speed:
KM-2560: Max. 25/12.5 pages per minute A4/A3
KM-3060: Max. 30/15 pages per minute A4/A3
Resolution: 600 x 600 dpi (copy), 1,800 dpi level x 600 dpi (copy, photo mode), 1200 dpi quality (print)
Time to first copy:
KM-2560/KM-3060: 4.7 seconds or less
Warm-up time: 29 seconds or less from power on
Power source: AC 220 - 240 V, 50/60 Hz
Power consumption: Printing: 560 W, Stand-by: 160 W, Power-Saving (ECOpower): 8.7 W
Noise (ISO 7779):
KM-2560: Printing/Copying: 64.7 dB(A)
KM-3060: Printing/Copying: 66.5 dB(A)
Stand-by: 47 dB(A), Power-Saving (ECOpower): Immeasurably low
Dimensions (W x D x H): Main unit: 570 x 620 x 767.2 mm
Weight: Main unit: Approx. 75 kg
Certifications: TÜV/GS, CE, ISO 15408 (under evaluation)
This product is manufactured according to ISO 9001 quality standard and ISO 14001 environmental standard.

PAPER HANDLING

All paper capacities quoted are based on a paper thickness of max. 0.11 mm. Please use paper recommended by Kyocera under normal environmental conditions.

Input capacity: 2 x 500-sheet universal paper feeder, 60-120 g/m², A3-A5R, Folio
200-sheet multi-purpose tray, 45-200 g/m², A3-A6R, Folio, envelopes
Max. input capacity with options: 2,200 sheets
Duplex as standard supports A3-A5, 60-80 g/m²
Output capacity: 250 sheets face-down

COPY FUNCTIONS

Max. original size: A3
Continuous copying: 1-999
Memory capacity: Standard 512 MB (max. 1 GB) + 80 GB HDD (system shared)
Zoom range: 25-400% in 1% steps (with DP-670: 25-200%)
Preset magnification ratios: 5R / 5E
Digital features: Interrupt output job, scan once print many, electronic sort, rotate sort, rotate copy, N-up copy, split copy, cover mode, page numbering, box image overlay, margin shift, border erase
Exposure mode: Auto, manual: 7 or 13 steps
Image adjustments: Text + photo, text, photo

PRINT FUNCTIONS

Processor: PowerPC 750Cxr / 400 MHz
Memory: Standard 512 MB (max. 1 GB) + 80 GB HDD (system shared)
Emulations: PCL6 incl. P.J.L, KPDL 3 (PostScript 3 compatible) Line Printer, IBM Proprinter X24E, Epson LQ-850, Diablo 630, KC-GL, PDF direct print
Controller language: PRESCRIBE IIe
Fonts: 80 outline fonts (PCL6), 136 PostScript KPDL 3 fonts, 1 bitmap font, 45 types of one-dimensional barcodes plus two-dimensional barcode (PDF-417)
Downloadable fonts: Kyocera, PCL + TrueType format, Type 1 + 3 format
Features: eMPS - for quick copy, proof and hold, private print, job storage and job management functionality

Interfaces

Standard interface: USB 2.0 (Hi-Speed), USB Host Interface dedicated for USB Flash Memory device, Fast Ethernet 10-Base-T/ 100Base-TX, CF slot
Multiple interface connection (MIC): Allows simultaneous data transfer via up to four interfaces, with each interface having its own virtual printer.

SCAN FUNCTIONS

Functionality: Scan-to-SMB/FTP, scan-to-email, scan-to-BOX, network TWAIN, BOX TWAIN
Scan speed: 50 originals per minute in b/w (300 dpi/A4), 15 originals per minute in colour (300 dpi/A4), 30 originals per minute in b/w (600 dpi/A4), 15 originals per minute in colour (600 dpi/A4)
Scan resolution: 600, 400, 300, 200, 200 x 400, 200 x 100 dpi (256 greyscales, 256 colour)*
Max. scan size: A3
Original recognition: Text, photo, text + photo, OCR
Interface: 10Base-T/100Base-TX
Network protocol: TCP/IP
File types: Mono: TIFF, PDF
Colour: JPEG, PDF, TIFF (JPEG)
Compression format: B/W: G4 (MMR), Colour: JPEG
Bundle software: KM-NET Viewer, TWAIN source

*Colour scanning at resolutions of 400 dpi and above requires additional memory.

FAX FUNCTIONS (OPTIONAL)

Compatibility: ITU-T Super G3
Modem speed: Max. 33.6 kbps
Transmission speed: 3 seconds or less (JBIG)
Scanning density: Normal: 8 dot/mm x 3.85 line/mm, Fine: 8 dot/mm x 7.7 line/mm, Superfine: 8 dot/mm x 15.4 line/mm, Ultrafine: 16 dot/mm x 15.4 line/mm, SUFine: 600 x 600 dpi
Max. original size: A3
Compression method: JBIG, MMR, MR, MH
Memory: Standard 120 MB (enable fax image back up)
Features: Internet fax, network fax, rotate transmission, confidential, relay and bulletin board transmission delivery to document box

OPTIONS

Fax System (M)

Paper handling
DP-670 Document processor: 75 sheets, 45-160 g/m², A3-A5R, Folio (RADF), colour scan
PF-670 Paper feeder: 2 x 500 sheets, 60-120 g/m², A3, A4, A4R, A5R, B4, B5, B5R, Letter, Letter-R, Legal, Ledger, Folio, STMT

DF-670 Document finisher: Max. 500 sheets A4 or 250 sheets A3, Folio, 60-105 g/m², one position stapling max. 30 sheets A4 or 20 sheets A3
DF-730 Document finisher + AK-670: Max. 1,000 sheets A4 or 500 sheets A3/B4, 64-128 g/m², A3-B5, one position stapling max. 30 sheets A4 or 20 sheets A3/B4, 64-128 g/m²
JS-670 Job separator: 100 sheets internal job separator, 45-160 g/m², A3-A5R

*Adapter-Kit AK-670 is required for the use of DF-730 document finisher.

Memory

DIMM memory: 512 MB memory, DDR-SDRAM DIMM (100 pin): 2 slots (1 slot empty), max. 1 GB
CompactFlash® card: 1 slot (up to 4 GB) for forms, fonts, logos, macro storage
BU-10 Back up memory: 128 MB for fax box image back up

Security

Data security kit (C)
UG-30: PDF expansion kit (high compression, encryption file)

Optional interface for print functions

SB-70 Network card: Wireless LAN - IEEE 802.11b
SB-110FX Network card: 10Base-T/100Base-TX/100Base-FX, FibreOptic
SB-110 Network card: 10Base-T/100Base-TX

Others

Platen cover (D)
CB-670 Cabinet: Wooden desk with storage capacity

CONSUMABLES

TK-675 Toner-kit: Microfine toner for 20,000 pages with 6% coverage



Select your options to suit your needs:



Product depicted includes optional extras

Your Kyocera Business Partner:



pureprint®

CarbonNeutral® company

Printed by Beacon Press, a CarbonNeutral® company, using proprietary pureprint® environmental print technology.

KYOCERA MITA (UK) Ltd, 8 Beacontree Plaza, Gillette Way, READING RG2 0BS
Tel: 0118 931 1108, Fax: 0118 931 1108, email: info@kyoceramita.co.uk, www.kyoceramita.co.uk

Kyocera does not warrant that any specifications mentioned will be error-free. Specifications are subject to change without notice. Information is correct at time of going to press. All other brand and product names may be registered trademarks or trademarks of their respective holders and are hereby acknowledged.

